

# OPAL EL WALL – MOUNT

## INSTALLATION AND OPERATING INSTRUCTIONS

Twitoplast Company thanks you for purchasing the Opal EL –Electrical Operation. The Opal EL device enables zone/room temperature control, by means of adjusting the airflow through the damper. The **Opal EL** device was designed for optimal use to insure both quick installation and comfortable & perfect air condition temperature.

### System Configurations

#### 1. Stand Alone:

The **Opal EL** controls one Damper.

- 1 OPAL EL
- 2 Transformer
- 3 P-3 Motor
- 4 RJ-11 Black Cabel
- 5 Motor cable ±

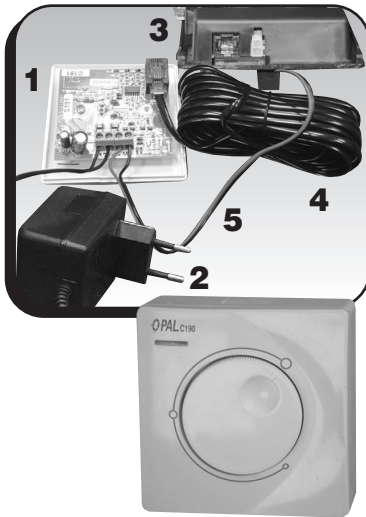

#### 2. As an Integral part of ZC-107 system.

The Opal EL controls one Damper, but has also an affect on the A/C operation it self through the Zone Control System



#### Containing :

- Opal EL – Dimmer.
- RJ-11 Cable.
- Electrical Motor P 3 .
- Motor Cabel ±.
- Installation & Operating Instructions.

**Please note: AC or DC 12 v Transformer not included.**  
Can be purchased separately.



## OPAL EL ELECTRICAL OPERATION (FOR DAMPER)

INSTALLATION  
AND  
OPERATING  
INSTRUCTION



WALL MOUNT

## Installation of the Opal EL

Remove the round knob and the screw. fasten the plastic box to the well. (step 1,2,3)

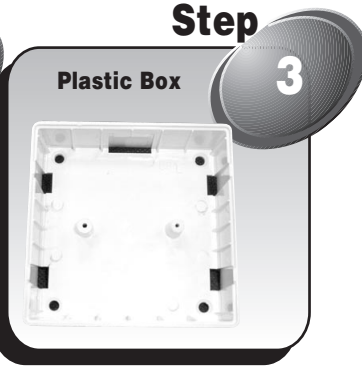

- Connect the:**
1. 12 v power supply cable from the transformer to the Opal EL.
  2. Black RJ 11 cable to the motor.
  3. Motor cable from the Opal EL to the motor (step 4 & 5).

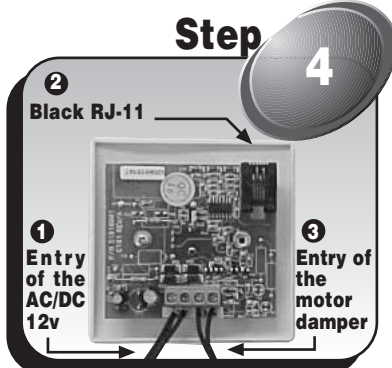

Take out the wires from the designate place in the plastic box (by cutting the plastic with a knife or drilling)

( Step 6 )

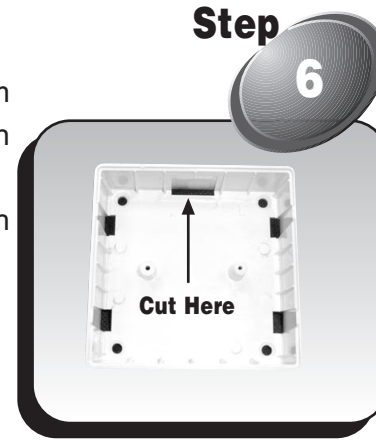

Put back the front panel of the Opal EL to the plastic box . Assemble the front panel of the Opal EL to its base using the screw. put back the round knob. (Step 7 & 8)



Connecting Scheme for stand alone.

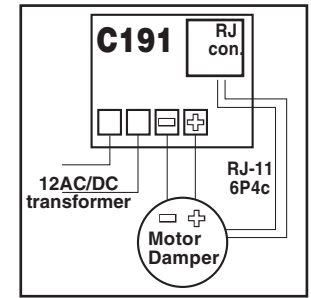

Connection of the OPAL EL to the Zone control System OPAL ZC-107

■ Repeat step 1&2 (stand alone).

■ Step1:

Connect one Black RJ-11 Cable from the damper to the RJ-11 splitter.

Step2:

Connect one Black RJ-11 Cable from the RJ-11 splitter to the OPAL EL.

Step3:

Connect one Black RJ-11 Cable (supply with the ZC-107) from the RJ-11 splitter to the Board of the ZC-107 (Scheme A).

■ Repeat steps 5,6,7.

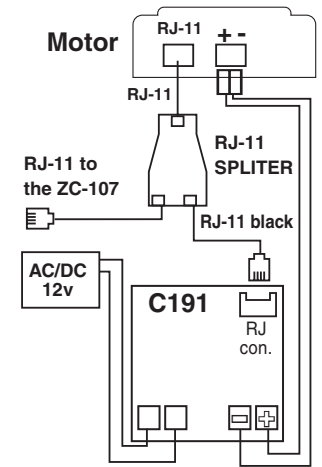

Please note this KIT does not include:

1. RJ-11 Splitter .
2. Black cable RJ-11.

Which you can purchased separate.

